

76'-0"

15'-8"

16CO7602
15'-8"x76' - 1191sqft

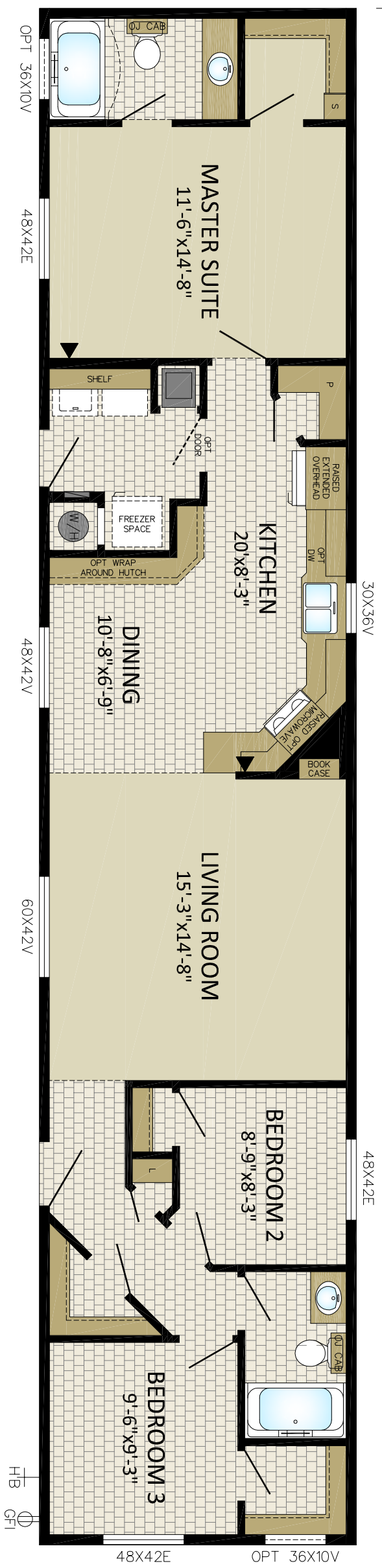

MODULINE INDUSTRIES ULC.
P.O. BOX 190
1175 RAILWAY STREET
PENICTON, B.C. V2A 6K3
(250) 493-0122

DRAWN BY: J.B.T.
DATE: 2-25-15
CHECKED BY:

NO.	REVISIONS:	INITIALS:	DATE:

TITLE:	CORNERSTONE	SERIAL NO.:	STANDARD
DRAWING NO.:	PENICTON		
	16CO7602		